

Technical data sheet

90° mesh cable tray bend, 55

Item no. 6001998

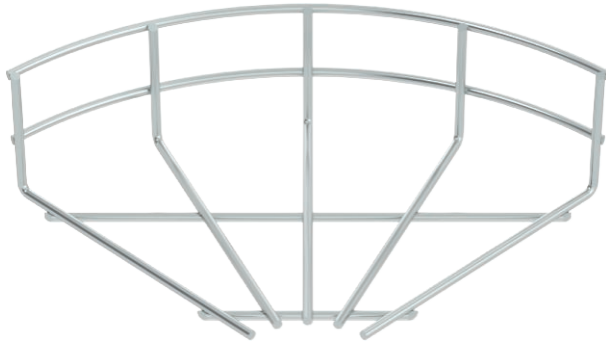

90° bend, horizontal, for all mesh cable trays of 55 mm side height.



St	Steel
G	Electrogalvanised

Master data

Item no.	6001998
Type	GRB 90 515 G
Description 1	90° mesh cable tray bend
Dimension	55x150
Material	Steel
Material symbol	St
Surface	Electrogalvanised
Surface to DIN	DIN EN 12329
Surface symbol	G
Smallest sales unit (VG)	1,00 Piece
Weight	14,40 kg/100 pc.

Technical data

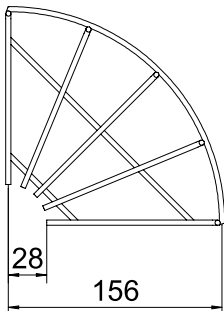
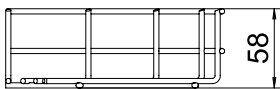

Width	150,00 mm
Side height	55,00 mm
Bend (angle)	90°
Connector version	Without connectors
Shape	Horizontal bend
Wire diameter	3,90 mm
Suitable for maintaining electrical function	<input type="checkbox"/>
Rustproof steel, pickled	<input type="checkbox"/>