



Cable entry with membrane for unassembled cables, Mounting type: Snap-on and screw, Length: 147 mm, Width: 58 mm, IP66, Colour: Grey

**RAL:** Ähnlich 7035

### Kaufmännische Daten

|  |                 |
|--|-----------------|
| Artikelnummer                              | <u>28645.6</u>  |
| Artikelbezeichnung                         | KES-GB 20/24 GR |
| GTIN (EAN)                                 | 4044211220143   |
| Packaging unit                             | 10              |
| Quantity unit                              | PC              |
| Weight per piece (not including packaging) | 114.44 g        |
| Weight per piece (including packaging)     | 121.44 g        |
| Unit of weight                             | G               |
| Customs number                             | 39259020        |
| Country of origin                          | DE              |
| Prio-Article                               | 28645.6         |
| Product description                        | Cable Entry     |

### Technische Daten

#### Dimensions

|                       |          |
|-----------------------|----------|
| Length                | 149.6 mm |
| Length of wall cutout | 112 mm   |
| Width                 | 58 mm    |
| Width of wall cutout  | 36 mm    |
| Installation height   | 14.5 mm  |

#### Materials

|                           |               |
|---------------------------|---------------|
| Material                  | Polyamide 6.6 |
| Glass-fibre reinforced    | ✓             |
| Flammability class UL 94  | V-0           |
| Working temperature, min. | -40 °C        |
| Working temperature, max. | 90 °C         |
| Sealing material          | TPE           |
| Halogen-free              | ✓             |
| Silicone-free             | ✓             |

#### Further technical data

|  |                             |
|--|-----------------------------|
| Mounting type                                      | Snap-on and screw-on        |
| Degree of protection                               | IP66                        |
| Sheet thickness min.                               | 1.5 mm                      |
| Sheet thickness max.                               | 2 mm                        |
| NEMA Type  | 1, 12, 4x (indoor use only) |
| Number of screw holes                              | 4                           |
| Fixing screws                                      | M4 (ISO 4762 / DIN 912)     |
| Torque of the fixing screws                        | 3 Nm                        |
| Number of wires                                    | 20                          |
| Number of cables for cable diameters 3.2 - 6.3 mm  | 12                          |
| Number of cables for cable diameters 5.5 - 10.5 mm | 8                           |

---

### Zulassungen

---

#### cUL Recognized

---

|              |                 |
|--------------|-----------------|
| cUL approval | C22.2 No. 14-18 |
|--------------|-----------------|

---

|                 |         |
|-----------------|---------|
| cUL File Number | E489821 |
|-----------------|---------|

---

|                |   |
|----------------|---|
| cUL Recognized | 1 |
|----------------|---|

---

#### UL Recognized

---

|             |         |
|-------------|---------|
| UL approval | UL 508A |
|-------------|---------|

---

|                |         |
|----------------|---------|
| UL File Number | E489821 |
|----------------|---------|

---

|               |   |
|---------------|---|
| UL Recognized | 1 |
|---------------|---|

---

|                |                             |
|----------------|-----------------------------|
| UL Type Rating | 1, 12, 4x (indoor use only) |
|----------------|-----------------------------|

---

### Medien



**C** **9** <sup>®</sup> **US**

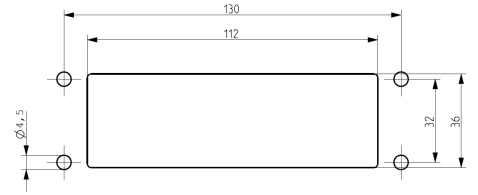

### Zubehör

#### EMC brackets



Shield-connection rail enabling mounting of shield connection clips directly on cable entry system KDS and KES, Mounting type: Screw, Length: 35,3 mm, Width: 140 mm, Height: 16 mm, Profile: 10x3 mm

| Artikelnummer  | Artikelbezeichnung | GTIN (EAN)    | VPE  |
|----------------|--------------------|---------------|------|
| <u>28626.0</u> | KDS-EMV-SAB 10/24  | 4044211219659 | 1 ST |

#### Sheet-metal puncher



Sheet metal puncher for rectangular openings, Dimensions opening: 112 x 36 mm, Maximum wall thickness: 2.0 mm for stainless steel sheet, Material: steel

| Artikelnummer  | Artikelbezeichnung | GTIN (EAN)    | VPE  |
|----------------|--------------------|---------------|------|
| <u>28752.0</u> | BL-VA KES          | 4044211221935 | 1 ST |



Sheet metal puncher for rectangular openings, Dimensions opening: 112 x 36 mm, Maximum wall thickness: 2.0 mm for S 235 sheet, Material: steel

| Artikelnummer  | Artikelbezeichnung | GTIN (EAN)    | VPE  |
|----------------|--------------------|---------------|------|
| <u>28744.0</u> | BL KES             | 4044211221942 | 1 ST |