

VBM-M

Accessories

Fitting sleeve, connection metric to metric inner thread

Temperature: -40°C ... +200°C

Material: nickel-plated brass

CHARACTERISTICS:

- Properties: high stability

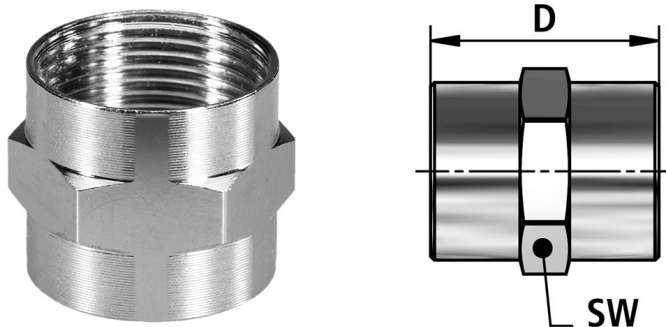

Characteristics	Unit	Value	Test
<b>Thermal characteristics</b>			
Temperature range	°C	-40°C ... +200°C	

FLEXA No.	Inner thread	Inner thread	D [mm]	WS [mm]	Weight [kg/100]	PU [pcs.]
10527001016	M16x1,5	M16x1,5	18,0	19	1,850	20
10527001020	M20x1,5	M20x1,5	22,0	22	3,300	20
10527001025	M25x1,5	M25x1,5	24,0	28	5,500	10
10527001032	M32x1,5	M32x1,5	30,0	35	7,700	10
10527001040	M40x1,5	M40x1,5	37,0	45	12,200	5
10527001050	M50x1,5	M50x1,5	37,0	52	6,400	5

<sup>3</sup> Article contains up to 4% lead, which is listed in SVHC list.

Recommendations for any areas of applications, products, or product combinations are issued to the best of FLEXA's knowledge and experience. The user is requested to check applicability of FLEXA products to specific applications and purposes prior to the use of the particular products. All documentation, illustrations, and charts published are subject to copyright and must not be copied, changed, used, or modified. Technical drawings, certificates, authorizations, and results by the FLEXA lab will be provided upon request. FLEXA will not be held liable for typographical or other errors and incorrect drawings. Technical modifications are subject to change without prior notice.